

Load direction  
加载方向

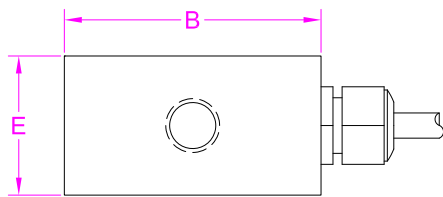
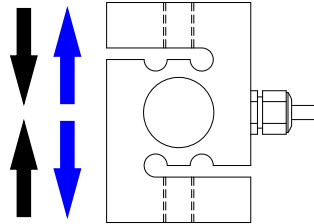

**Ordering example**

**FSRS-500kg**

Model

Capacity

**Wiring Diagram**

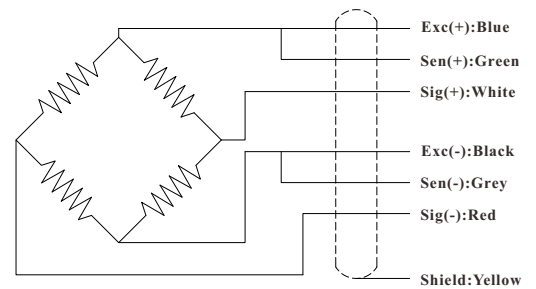

Capacity	A	B	E	M
50kg	63.5	50.8	25.4	M8
100/200 kg	76.2	50.8	25.4	M12
500kg/1t	87.3	57.2	31	M12
2t/3t	100	69.8	36.5	M24*2
5t	114.3	76.2	36.5	M24*2

--- Specifications / 规格参数 ---

Capacity/量程	50/100/200/500/1000/2000/3000/5000 kg		
Rated Output 额定输出	2.0±0.01 mV/V	Compensated Temp. 温度补偿范围	-10...+40°C
Excitation 激励电压	3~15V	Operating Temp. 工作温度范围	-30...+70°C
Zero Balance 零点输出	±0.01mV/V	Temp. Shift Zero 零点温度漂移	±0.02% of R.O./10°C
Nonlinearity 非线性	±0.02% of R.O.	Temp. Shift Span 灵敏度温度漂移	±0.02% of R.O./10°C
Hysteresis 滞后	±0.02% of R.O.	Input Resistance 输入阻抗	350±30Ω
Nonrepeatability 非重复性	±0.02% of R.O.	Output Resistance 输出阻抗	350±5Ω
Creep(30min) 蠕变	±0.03% of R.O.	Insulation Resistance 绝缘阻抗	>5000MΩ(50V)
Safe Overload 安全过载	150% of F.S.	Ingress Protection 防护等级	IP68
Ultimate Overload 极限过载	200% of F.S.	Material of Element 弹性体材料	Stainless steel 不锈钢
Cable 导线	Ø5.3*3000mm 6-core shielded cable Ø5.3*3000mm 6芯屏蔽线		
R.O.=Rated Output/额定输出 F.S.=Full Scale/满量程			

• Subject to change without notice / 如有更改,不另行通知